

CODE REFERENCES:

2007 CBC Section No. 2305.2

ISSUE:

As indicated in the attached diagram, the engineer has proposed a continuous 3-inch gap at the ridge of a simple gabled end roof system to allow for attic ventilation.

BACKGROUND:

?

DISCUSSION / OPTIONS:

Does this create an open ended diaphragm ? The diaphragm shear at the ridge location is zero. "Something" does not "feel" right !!

Plywood is held back 1.5 inches on each side.

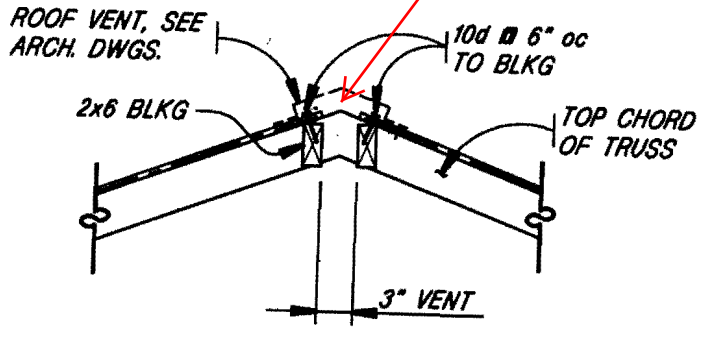

F 22